

RIFFEL

GIPFEL DES ERFOLGS

Washing Machine

OWNER'S MANUAL

WRFM 81201 S

Read This Manual

Use all instructions and explanations of the installation before use. Follow the instructions carefully. Keep the operation instructions handy for later use. If the application is sold or passed on then ensure that the new owner always receives those operation instructions.

www.riffelappliances.de

Contents

Safety Instructions

■ Safety Instructions	2
-----------------------------	---

Installation

■ Product Description	7
■ Installation	8

Operations

■ Quick Start	11
■ Before Each Washing	12
■ Detergent Dispenser	13
■ Control Panel	14
■ Option.....	15
■ Other Functions	16
■ Programmes.....	18
■ Washing Programmes Table	19

Maintenances

■ Cleaning And Care	22
■ Trouble Shooting	25
■ Technical Specifications	26
■ Product Fiches	27

SAFETY INSTRUCTIONS

■ Safety Instructions

For your safety, the information in this manual must be followed to minimize the risk of fire or explosion, electric shock, or to prevent property damage, personal injury or loss of life.

Explanation of the symbols:

Warning!

This combination of symbol and signal word indicates a potentially dangerous situation which may result in death or serious injuries unless it's avoided.

Caution!

This combination of symbol and signal word indicates a potentially dangerous situation which may result in slight or minor injuries or damage to property and the environment.

Note!

This combination of symbol and signal word indicates a potentially dangerous situation which may result in slight or minor injuries.

Warning!

The electric shock!

- If the supply cord is damaged, it must be replaced by the manufacturer, its service agent or similarly qualified persons in order to avoid a hazard.

SAFETY INSTRUCTIONS

- The new hose-sets supplied with the appliance are to be used and that old hose-sets should not be reused.
- Before any maintenance the device, unplug the appliance from the mains.
- Always unplug the machine and turn off the water supply after use. The max. inlet water pressure, in pascals. The min. inlet water pressure, in pascals.
- To ensure your safety, power plug must be inserted into an earthed three-pole socket. Check carefully and make sure that your socket is properly and reliably earthed.
- Make sure that the water and electrical devices must be connected by a qualified technician in accordance with the manufacturer's instructions and local safety regulations.

Risk to children!

- EN countries: the appliance can be used by children aged from 8 years and above and persons with reduced physical, sensory or mental capabilities or lack of experience and knowledge if they have been given supervision or instruction concerning use of the appliance in a safe way and understand the hazards involved. Children shall not play with the appliance. Cleaning and user maintenance shall not be made by children without supervision.
- Children of less than 3 years should be supervised to ensure that they do not play with appliance.
- Animals and children may climb into the machine. Check the machine before every operation.
- Kids should be supervised that they do not play with the appliance.

SAFETY INSTRUCTIONS

- Glass door may be very hot during the operation. Keep kids and pets far away from the machine during the operation very wet rooms as well as in the rooms with explosive or caustic gas.
- Remove all packages and transport bolts before using the appliance. Otherwise, serious damage may result.
- Plug must be accessible after installation.

Risk of explosion!

- Do not wash or dry articles that have been cleaned in, washed in, soaked in, or dabbed with combustible or explosive substances(such as wax, oil, paint, gasoline, degreasers, dry-cleaning solvents, kerosene, etc.) This may result in fire or explosion.
- Before hand thoroughly rinse items of washing by hand.

⚠ Caution!

Installing the product!

- This washing machine is for indoor use only.
- It isn't intended to be built-in using.
- The openings must not be obstructed by a carpet.
- Washing machine shall not be installed in bath room or very wet rooms as well as in the rooms with explosive or caustic gases.
- The washing machine with single inlet valve only can be connected to the cold water supply. The product with double inlet valves should be correctly connected to the hot water and cold water supply.
- Plug must be accessible after installation.

SAFETY INSTRUCTIONS

- Remove all packages and transport bolts before using the appliance. Otherwise, serious damage may result.

Risk of damaging appliance!

- Your product is only for home use and is only designed for the textiles suitable for machine washing.
- Do not climb up and sit on top cover of the machine.
- Do not lean against machine door.
- Cautions during Handling Machine:
 1. Transport bolts shall be reinstalled to the machine by a specialized person.
 2. The accumulated water shall be drained out of the machine.
 3. Handle the machine carefully. Never hold each protruded part on the machine while lifting. Machine door can not be used as the handle during the conveyance.
 4. This appliance is heavy. Transport with care.
- Please do not close the door with excessive forces. If it is found difficult to close the door, please check if the clothes are put in or distributed well.
- It is forbidden to wash carpets.

Operating the appliance!

- Before washing the clothes at first time, the product shall be operated in one round of the whole procedures without the clothes inside.
- Flammable and explosive or toxic solvents are forbidden. Gasoline and alcohol etc. Shall not be used as detergents. Please only select the detergents suitable for machine washing, especially for drum.

SAFETY INSTRUCTIONS

- Make sure that all pockets are emptied. Sharp and rigid items such as coin, brooch, nail, screw or stone etc. may cause serious damages to this machine.
- Please check whether the water inside the drum has been drained before opening its door. Please do not open the door if there is any water visible.
- Be careful of burning when the product drains hot washing water.
- Never refill the water by hand during washing.
- After the program is completed, Please wait for two minutes to open the door.

Packaging/Old appliance



This marking indicates that this product should not be disposed with other household wastes throughout the EU. To prevent possible harm to the environment or human health from uncontrolled waste disposal, recycle it responsibly to promote the sustainable reuse of material resources. To return your used device, please use the collection systems or contact the retailer where the product was purchased. They return and can take this product for environmental safe recycling.

INSTALLATION

■ Product Description

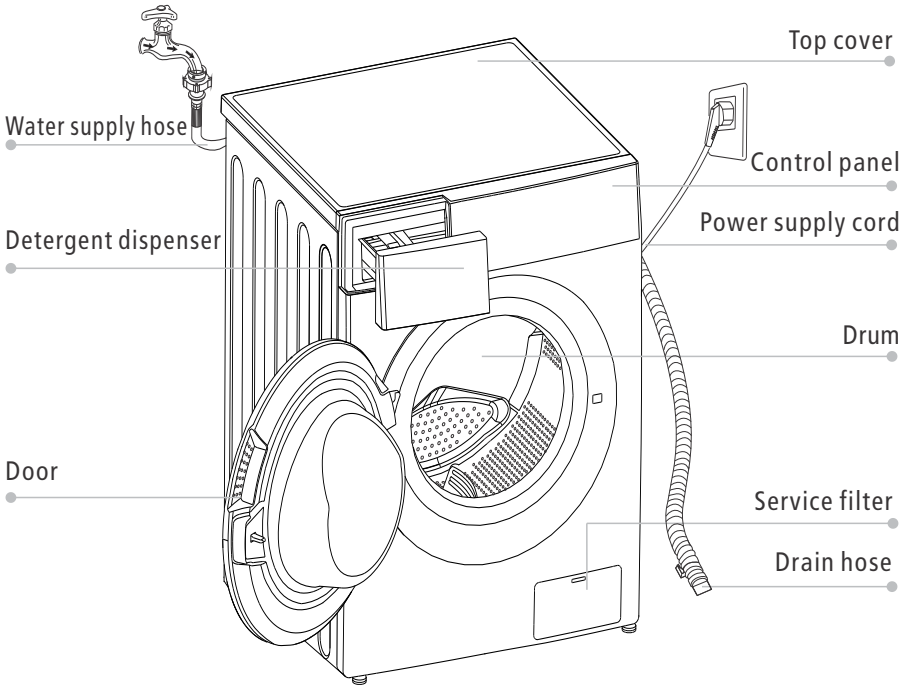

Note!

- The product line chart is for reference only, please refer to real product as standard.

Accessories

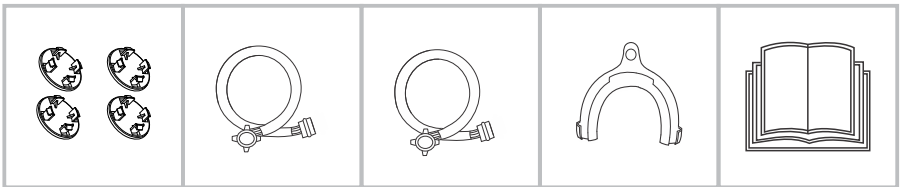

Transport hole plug

Supply hose cold water

Supply hose hot water (optional)

Drain hose support (optional)

Owner's manual

INSTALLATION

■ Installation

Installation area

⚠ Warning!

- Stability is important to prevent the product from wandering!
- Make sure that the product should not stand on the power cord.

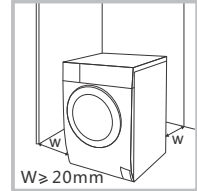

Before installing the machine, the location characterized as follows shall be selected:

1. Rigid, dry, and level surface
2. Avoid direct sunlight
3. Sufficient ventilation
4. Room temperature is above 0°C
5. Keep far away from the heat resources such as coal or gas.

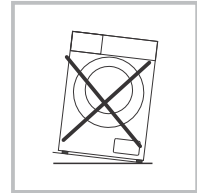

Unpacking the washing machine

⚠ Warning!

- Packaging material (e.g. Films, Styrofoam) can be dangerous for children.
- There is a risk of suffocation ! Keep all packaging well away from children.

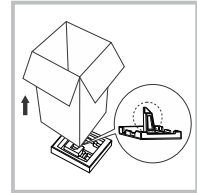

1. Remove the cardboard box and styrofoam packing.
2. Lift the washing machine and remove the base packing. Make sure the small triangle foam is removed with the bottom one together. If not, lay the unit down with side surface, then remove the small foam from the unit bottom manually.
3. Remove the tape securing the power supply cord and drain hose.
4. Remove the inlet hose from the drum.

Remove transport bolts

⚠ Warning!

- You must remove the transport bolts from the backside before using the product.
- You'll need the transport bolts again if you move the product, so make sure you keep them in a safe place.

Please take the following steps to remove the bolts:

1. Loosen 4 bolts with spanner and then remove them.
2. Stop the holes with transport hole plugs.
3. Keep the transport bolts properly for future use.

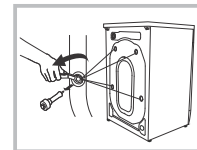

INSTALLATION

Levelling the washing machine

⚠ Warning!

- The lock nuts on all four feet must be screwed tightly against the housing.

1. Check if the legs are closely attached to the cabinet. If not, please turn them to their original positions tighten the nuts.
2. Loosen the lock nut turn the feet until it closely contacts with the floor.
3. Adjust the legs and lock them with a spanner, make sure the machine is steady.

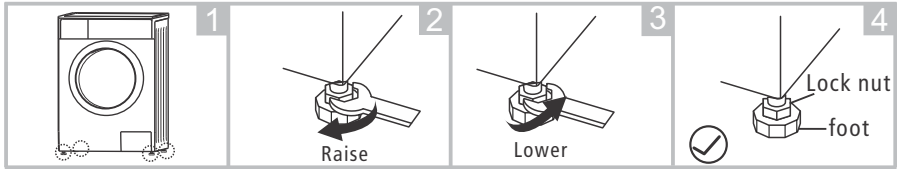

Connect Water Supply Hose

⚠ Warning!

- To prevent leakage or water damage, follow the instructions in this chapter!
- Do not kink, crush, modify or sever water inlet hose.
- For the model equips hot valve, connect it to hot water tap with hot water supply hose. Energy consumption will decrease automatically for some program.

Connect the inlet pipe as indicated, There are two ways to connect the inlet pipe.

1. Connection between ordinary tap and inlet hose.

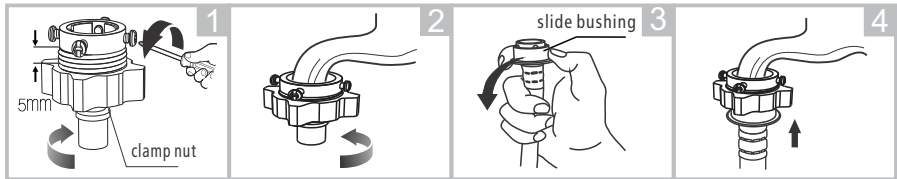

Loosen clamp nut and four bolts

Tighten clamp nut

Press slide bushing, insert inlet hose into connecting base

Connection finished

2. Connection between screw tap and inlet hose.

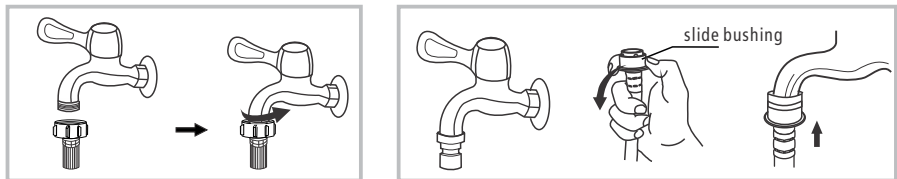

Tap with threads and inlet hose

Special tap for washing machine

INSTALLATION

Connect the other end of inlet pipe to the inlet valve at the backside of product and fasten the pipe tightly clockwise.

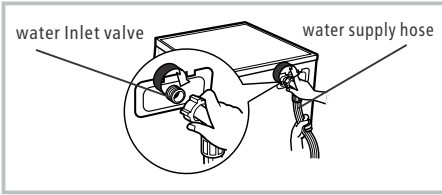

Drain Hose

⚠ Warning!

- Do not kink or protract the drain hose.
- Position drain hose properly ,otherwise damage might result of water leakage.

There are two ways to place the end of drain hose:

1.Put it into the water trough.

2.Connect it to the branch drain pipe of the trough.

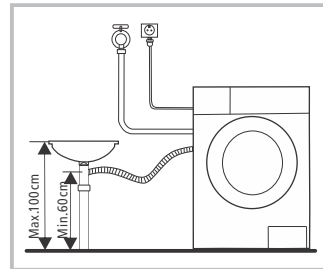
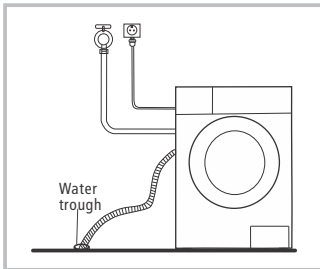

📌 Note!

- If the machine has drain hose support, please install it like the following .

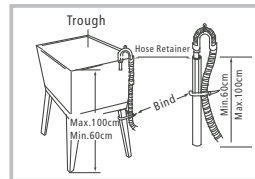
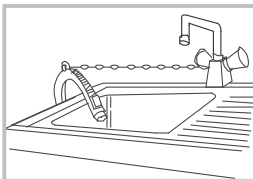

⚠ Warning!

- When installing drain hose, fix it properly with a rope.
- If drain hose is too long, do not force it into washing machine as it will cause abnormal noises.

OPERATIONS

■ Quick Start

⚠ Caution!

- Before washing, please make sure it's installed properly.
- Before washing it first time, the washing machine shall be operated in one round of the whole procedures without clothes in as follows.

1. Before Washing

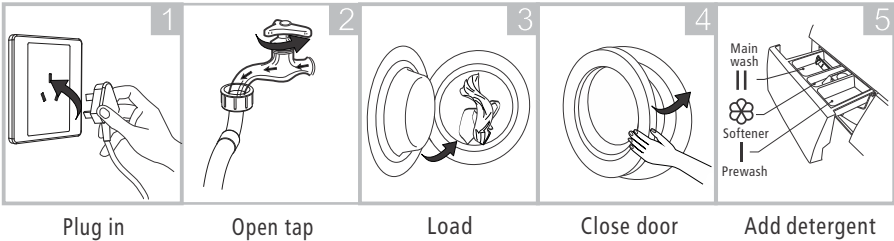

📌 Note!

- Detergent only need to be added in "case I" after selecting pre-washing for machines with this function.

2. Washing

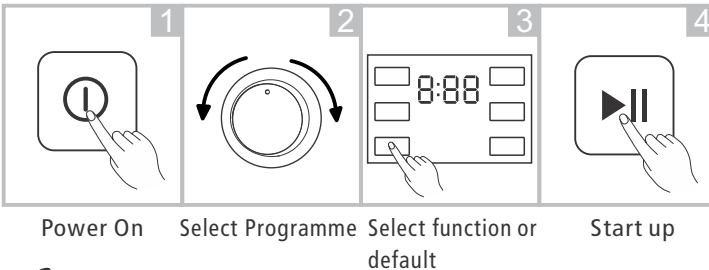

📌 Note!

- If default is selected, step 3 can be skipped.

3. After Washing

Buzzer beep or "End" on display.

OPERATIONS

■ Before Each Washing

- The working condition of the washer should be (0-40)°C. If used under 0°C, the inlet valve and draining system may be damaged. If the machine is placed under condition of 0°C or less, then it should be transferred to normal ambient temperature to ensure the water supply hose and drain hose are not frozen before use.
- Please check the labels and the explanation of using detergent before wash. Use non-foaming or less-foaming detergent suitable for machine washing properly.

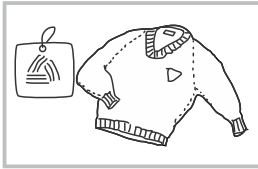

Check the label



Take out the items out of the pockets

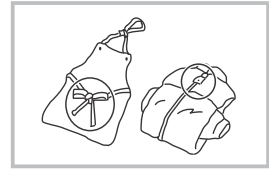

Knot the long strips, zip or button

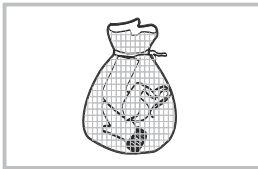

Put small clothes into the pillow slip

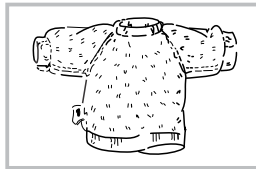

Turn easy-pilling and long-pile fabric inside out

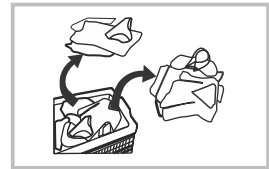

Separate clothes with different textures

⚠ Warning!

- When washing a single clothes, it may easily cause great eccentricity and give alarm due to great unbalance. Therefore it is suggested to add one or two more clothes to be washed together so that draining can be done smoothly.
- Don't washing the clothes touching with kerosene, gasoline, alcohol and other flammable materials.

OPERATIONS

■ Detergent Dispenser

- I Pre wash detergent
- II Main wash detergent
- ☼ Softener

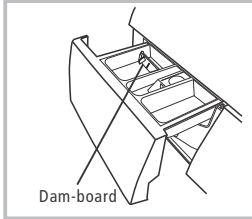

Dam-board

Liquid detergent

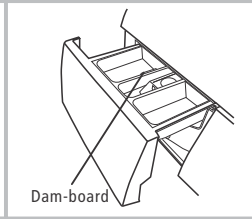

Dam-board

Powder detergent

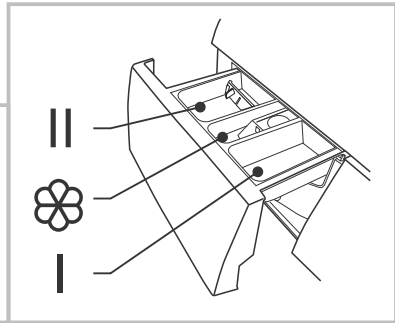

Pull out the dispenser

⚠ Caution!

- Detergent only need to be added in "case I "after selecting pre-washing for machines with this function.

Programme	I	II	☼	Programme	I	II	☼
Cotton	○	●	○	Rinse&Spin			○
Synthetic	○	●	○	Wool		●	○
Baby Care	○	●	○	Delicate		●	○
Jeans	○	●	○	Quick		●	○
Mix	○	●	○	Mix		●	○
Colors		●	○	Sport Wear	○	●	○
Drain Only				Hand Wash	○	●	○
Spin Only				Cotton ECO		●	○

- Means must
- Means optional

📌 Note!

- As for the agglomerated or ropy detergent or additive, before they are poured into the detergent box, it is suggested to use some water for dilution to prevent the inlet of detergent box from being blocked and overflowing while filling water.
- Please choose suitable type of detergent for the various washing temperature to get the best washing performance with less water and energy consumption.

OPERATIONS

Control Panel

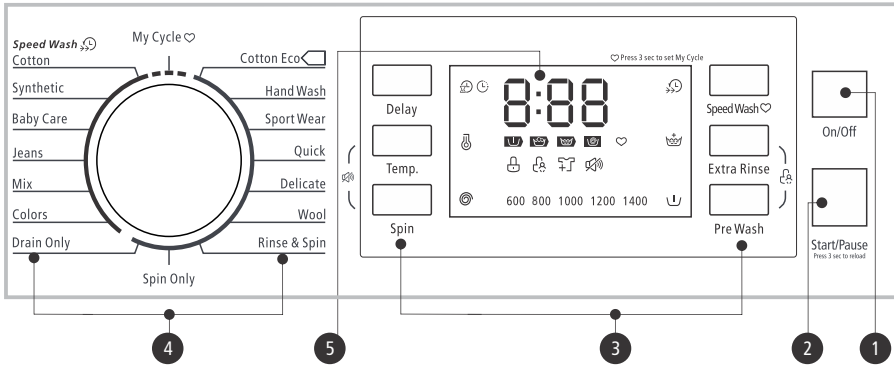

Note!

- The chart is for reference only, Please refer to real product as standard.

1 On/Off

Product is switched on or off.

2 Start/Pause

Press the button to start or pause the washing cycle.

3 Option

This allows you to select an additional function and will light when selected.

4 Programmes

Available according to the laundry type.

5 Display

The display shows the settings, estimated time remaining, options, and status messages for your washer. The display will remain on through the cycle.

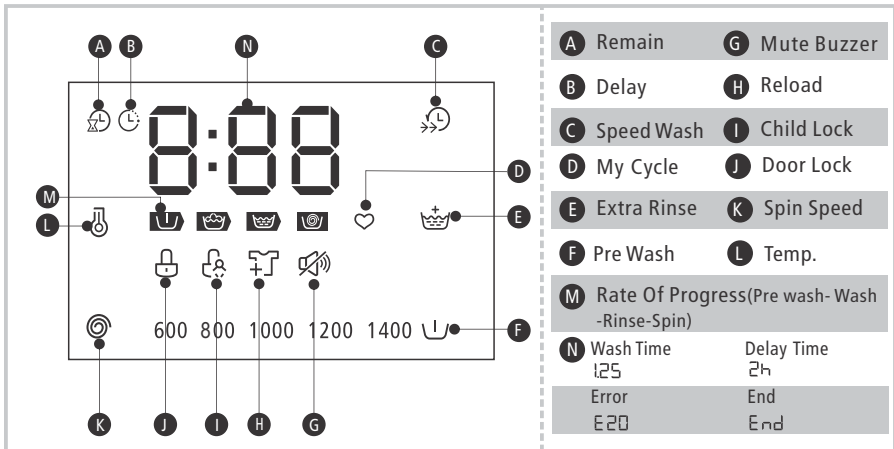

OPERATIONS

Control Panel

Model:MFC120-U1203B/C14E-TW

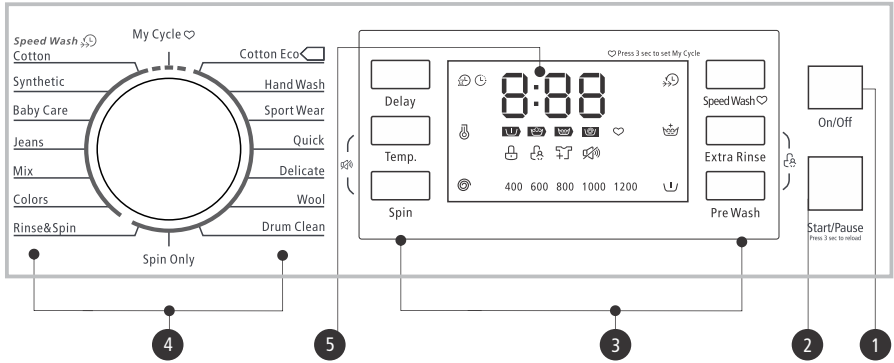

Note!

- The chart is for reference only, Please refer to real product as standard.

1 On/Off

Product is switched on or off.

2 Start/Pause

Press the button to start or pause the washing cycle.

3 Option

This allows you to select an additional function and will light when selected.

4 Programmes

Available according to the laundry type.

5 Display

The display shows the settings, estimated time remaining, options, and status messages for your washer. The display will remain on through the cycle.

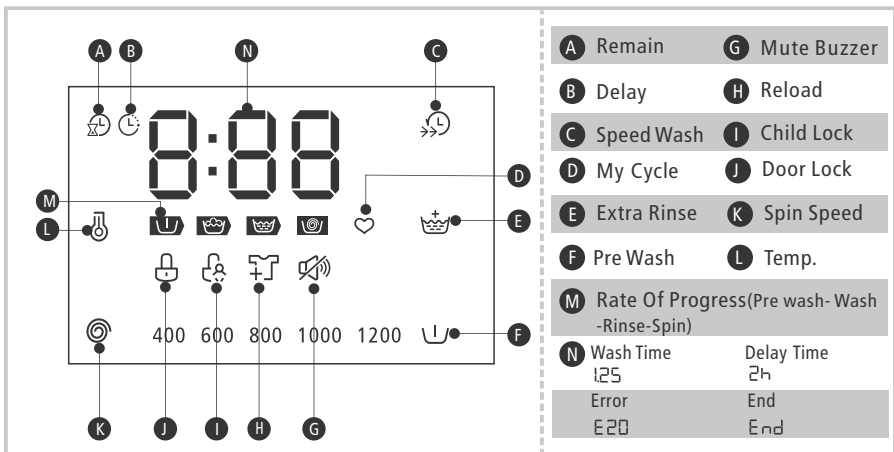

OPERATIONS

■ Option



Pre Wash

The Prewash function can get an extra wash before main wash, it is suitable for washing the dust rises to surface of the clothes; You need to put detergent into the Case (I) when select it.



Extra Rinse

The laundry will undergo extra rinse once after you select it.



Speed Wash

The function can decrease the washing time.



Delay

Set the Delay function:

1. Select a programme
2. Press the Delay button to choose the time (the delaying time is 0-24 H.)
3. Press [Start/Pause] to commence the delay operation



On/Off



Choose the Programme



Setting time



Start

Cancel the Delay function:

Press the [Delay] button until the display be 0H. It should be pressed before starting the programme. If the programme already started, should press the [On/Off] button to reset the programme.

ⓘ Caution!

- If there is any break in the power supply while the machine is operating, a special memory stores the selected programme and when the power is restarted, press the [Start/Pause] button the program will continues.

Programme	Option				Programme	Option			
	Delay	Speed wash	Extra rinse	Pre wash		Delay	Speed wash	Extra rinse	Pre wash
Cotton	○	○	○	○	Rinse&Spin	○		○	
Synthetic	○	○	○	○	Wool	○		○	
Baby Care	○	○	○	○	Delicate	○		○	
Jeans	○	○	○	○	Quick	○			
Mix	○	○	○	○	Sport Wear	○		○	○
Colors	○	○	○		Hand Wash	○		○	○
Drain Only	○				Cotton ECO	○			
Spin Only	○				Drum Clean	○			

○ Means optional

OPERATIONS

■ Other functions



Reload

This operation can be executed during the washing progress. When the drum is still rolling and there is large amount of water with high temperature in the drum. The state is unsafe and the door cannot be opened forcefully. To press [Start/Pause] for 3 sec. to reload, and start the clothes adding in the midway function. Please follow the steps as bellow:

- 1.Wait until the drum stops rotation.
- 2.The door lock is unlocked.
- 3.Close the door when the clothes are reloaded and press the [Start/Pause] button.



Press [Start/Pause] 3sec.



Reload the clothes



Start

⚠ Caution!

- Don't use the Reload function when the water level over the edge of the inner tub or the temperature is higher.



Child Lock

To avoid mis operation by children.



On/Off



Start



Press [Extra Rinse] and [Pre Wash]
3 sec. till buzzer beep.

⚠ Caution!

- Press the two button 3sec. also to be released the function.
- The "Child Lock" will lock all buttons except [On/Off].
- Cut off the power supply , the kid's protection is to be released.
- The child lock will remain effective when the power is resumed for some models.



My Cycle

Memory the frequently used programmes

Press [Speed Wash] 3sec. to memory the running programme.The default is cotton.



Temp.

Press the button to regulate the temperature(Cold,20°C,30°C, 40°C,60°C,90°C)

OPERATIONS

Spin

Spin

Press the button to change the spin speed.

1000: 0-400-600-800-1000

1200: 0-400-600-800-1000-1200

1400: 0-600-800-1000-1200-1400

1600: 0-400-800-1200-1400-1600

1400(LA/AR): 0-400-800-1200-1400

Programme	Default Speed(rpm)					Programme	Default Speed(rpm)				
	1000	1200	1400	1400 (LA20/AR)	1600		1000	1200	1400	1400 (LA20/AR)	1600
Cotton	800	800	800	800(AR) 1400(LA)	800	Rinse&Spin	800	800	1000	1200	1200
Synthetic	800	800	800	800(AR) 1200(LA)	800	Wool	600	600	600	800	800
Baby Care	800	800	800	800	800	Delicate	600	600	600	800	800
Jeans	800	800	800	800	800	Quick	800	800	800	800	800
Mix	800	800	800	800	800	Sport Wear	1000	1200	1200	1200	1200
Colors	800	1000	1000	1200	1200	Hand Wash	600	600	600	800	800
Drain Only	—	—	—	—	—	Cotton ECO	1000	1200	1400	1400	1600
Spin Only	800	800	1000	1200	1200	Drum Clean	—	—	—	—	—

⚠ Caution!

- When the lights of spin speed (600,800,1000,1200,1400) are off means the spin speed is 0.



Mute the buzzer



On/Off

Start

Press the [Temp.]&[Spin] button for 3sec.
the buzzer is mute.

To act the buzzer function, press the two buttons again for 3 seconds. The setting will be kept until the next reset.

⚠ Caution!

- After Muting the buzzer function, the sounds will not be activated any more.

OPERATIONS

■ Programmes

Programmes are available according to the laundry type.

Programmes	
Cotton	Hard-wearing textiles, heat-resistant textiles made of cotton or linen.
Synthetic	Wash synthetic articles, for example: shirts, coats, blending. While washing the knitting textiles, detergent quantity shall be reduced due to its loose string construction and easily forming bubbles.
Baby Care	Washing the baby's clothes, it can make the baby's wear cleaner and make the rinse performance better to protect the baby skin.
Jeans	Specially for jeans.
Mix	Mixed load consisting of textiles made of cotton and synthetics.
Colors	Washing brightly colored clothes, it can protect the colors better.
Cotton Eco	To increase the washing effects, washing time is increased.
Hand Wash	As for few light dirty clothes, the default temperature of washing is cold.
Sport Wear	Washing the activewear.
Quick	Extra short programme approx, suitable for lightly soiled washing as a small amounts of laundry.
Delicate	For delicate, washable textiles, e.g. made of silk, satin, synthetic fibres or blended fabrics.
Wool	Hand or machine-washable wool or richwool textiles. Especially gentle wash programme to prevent shrinkage, longer programme pauses (textiles rest in wash liquor).
Spin Only	Extra spin with selectable spin speed.
Rinse&Spin	Extra rinse with spin.
Drain Only	Drain off the water.
Drum Clean	This program is specially set in this machine to clean the drum and tube. It applies 90°C high temperature sterilization to make the clothes washing more green. When this procedure is performed, the clothes or other washing cannot be added. When proper amount of chlorine bleaching agent is put in, the barrel cleaning effect will be better. The customer can use this procedure regularly according to the need.

OPERATIONS

■ Washing Programmes Table

Model:EU(A3)-FC60-S10/C1903E/EU(A3)-FC60-S12/C1903E/EU(A3)-FC60-S14/C1903E
 /EU(A3)-FC70-S12/C1903E/EU(A3)-FC70-S14/C1903E/IR(A3)-FC70-S14S/C1903E
 /EU(A3)-FC80-S14/C1903E/IR(A3)-FC80-S14S/C1903E/EU(A31)-FC90-S14D/C1903E

Programme	Load(kg)				Temp.(°C)	Default Time						
	6.0	7.0	8.0	9.0		Default	6.0			7.0/8.0		9.0
							1000	1200	1400	1200	1400	1400
Cotton	6.0	7.0	8.0	9.0	40	2:40	2:40	2:40	2:40	2:40	2:40	
Synthetic	3.0	3.5	4.0	4.5	40	1:40	1:40	1:40	1:40	1:40	1:40	
Baby Care	6.0	7.0	8.0	9.0	30	1:20	1:20	1:20	1:20	1:20	1:20	
Jeans	6.0	7.0	8.0	9.0	60	1:45	1:45	1:45	1:45	1:45	1:45	
Mix	6.0	7.0	8.0	9.0	40	1:13	1:13	1:13	1:13	1:13	1:13	
Colors	3.0	3.5	4.0	4.5	Cold	1:10	1:10	1:10	1:10	1:10	1:10	
Drain Only	—	—	—	—	—	0:01	0:01	0:01	0:01	0:01	0:01	
Spin Only	6.0	7.0	8.0	9.0	—	0:12	0:12	0:12	0:12	0:12	0:12	
Rinse&Spin	6.0	7.0	8.0	9.0	—	0:20	0:20	0:20	0:20	0:20	0:20	
Wool	2.0	2.0	2.0	2.0	40	1:07	1:07	1:07	1:07	1:07	1:07	
Delicate	2.5	2.5	2.5	2.5	30	0:50	0:50	0:50	0:50	0:50	0:50	
Quick	2.0	2.0	2.0	2.0	Cold	0:15	0:15	0:15	0:15	0:15	0:15	
Sport Wear	3.0	3.5	4.0	4.5	40	0:45	0:45	0:45	0:45	0:45	0:45	
Hand Wash	2.0	2.0	2.0	2.0	Cold	1:00	1:00	1:00	1:00	1:00	1:00	
Cotton ECO	6.0	7.0	8.0	9.0	60	2:51	3:04	2:51	3:06	2:53	3:39	

- The EU energy efficiency class is A+++
 Energy test program: Cotton ECO 60/40°C.
 Speed: the highest speed; Other as the default.
 Half load for 6.0/7.0/8.0/9.0Kg machine:3.0/3.5/4.0/4.5Kg.
- "Cotton ECO 60/40°C " is the standard washing programs to which the information in the label and the fiche relates, and they are suitable to clean normally soiled cotton laundry and that they are the most efficient programmes in terms of combined energy and water consumptions for washing that type of cotton laundry, that the actual water temperature may differ from the declared cycle temperature.

Note!

- The parameters in this table are only for user's reference. The actual parameters maybe different with the parameters in above mentioned table.

OPERATIONS

■ Washing Programmes Table

Model:EU(A33)-FC100-U16B/C1903E/EU(A33)-FC120-U14B/C1903E/MFC120-U1203B/C14E-TW
/MFC120-U1401B/C14E-LA/MFC120-U1403B/C19E-AR/MFC120-U1403B5/C19E-LA20

Programme	Load(kg)		Temp.(°C)		Default Time			
	10.0	12.0	Default	Default (TW)	10.0/12.0	12.0 (AR)	12.0 (LA)	12.0 (TW)
Cotton	10.0	12.0	40	40	2:40	2:40	2:40	2:40
Synthetic	5.0	6.0	40	40	1:40	1:40	2:20	2:20
Baby Care	10.0	12.0	30	30	1:20	1:20	1:20	1:20
Jeans	10.0	12.0	60	60	1:45	1:45	2:15	2:15
Mix	10.0	12.0	40	40	1:13	1:13	1:29	1:29
Colors	5.0	6.0	Cold	Cold	1:10	1:10	1:10	1:10
Drain Only	—	—	—	—	0:01	0:01	0:01	—
Spin Only	10.0	12.0	—	—	0:12	0:12	0:12	0:12
Rinse&Spin	10.0	6.0	—	—	0:20	0:20	0:20	0:20
Wool	2.0	2.0	40	40	1:07	1:07	1:07	1:07
Delicate	2.5	2.5	30	30	0:50	0:50	1:00	1:00
Quick	2.0	2.0	Cold	Cold	0:15	0:15	0:15	0:15
Sport Wear	5.0	6.0	40	40	0:45	0:45	1:11	1:11
Hand Wash	2.0	2.0	Cold	Cold	1:00	1:00	1:00	1:00
Cotton ECO	10.0	12.0	60	Cold	3:59	4:05	2:17	2:29
Drum Clean	—	—	—	90	—	—	—	2:08

- The EU energy efficiency class is: A+++
The AR energy efficiency class is: AA
The LA20 energy efficiency class is: A .
(EU)Energy test program: Cotton ECO 60/40°C.
(LA20/AR/TW)Energy test program: Cotton ECO .
Speed: the highest speed; Other as the default.
Half load for 10.0/12.0Kg machine:5.0/6.0Kg.
- "Cotton ECO 60/40°C " is the standard washing programs to which the information in the label and the fiche relates, and they are suitable to clean normally soiled cotton laundry and that they are the most efficient programmes in terms of combined energy and water consumptions for washing that type of cotton laundry, that the actual water temperature may differ from the declared cycle temperature.

Note!

- The parameters in this table are only for user's reference. The actual parameters maybe different with the parameters in above mentioned table.

OPERATIONS

■ Washing Programmes Table(UAE)

Model:MFC60-S1203/C14E-AE(5)/MFC70-S1203/C14E-AE(5)/MFC80-S1403/C14E-AE(5)/
MFC60-U1203/C19E-EU(A3)

Programme	Load(kg)			Temp.(°C)	Default Time			
	6.0	7.0	8.0		Default	6.0	6.0(EU)	7.0
					1200	1200	1200	1400
Cotton	6.0	7.0	8.0	40	2:40	2:40	2:40	2:40
Synthetic	3.0	3.5	4.0	40	1:40	1:40	1:40	1:40
Baby Care	6.0	7.0	8.0	30	1:20	1:20	1:20	1:20
Jeans	6.0	7.0	8.0	60	1:45	1:45	1:45	1:45
Mix	6.0	7.0	8.0	40	1:13	1:13	1:13	1:13
Colors	3.0	3.5	4.0	Cold	1:10	1:10	1:10	1:10
Drain Only	—	—	—	—	0:01	0:01	0:01	0:01
Spin Only	6.0	7.0	8.0	—	0:12	0:12	0:12	0:12
Rinse&Spin	6.0	7.0	8.0	—	0:20	0:20	0:20	0:20
Wool	2.0	2.0	2.0	40	1:07	1:07	1:07	1:07
Delicate	2.5	2.5	2.5	30	0:50	0:50	0:50	0:50
Quick	2.0	2.0	2.0	Cold	0:15	0:15	0:15	0:15
Sport Wear	3.0	3.5	4.0	40	0:45	0:45	0:45	0:45
Hand Wash	2.0	2.0	2.0	Cold	1:00	1:00	1:00	1:00
Cotton ECO	6.0	7.0	8.0	60	2:37	4:32	2:39	2:41

- The **UAE Energy Efficiency class: ★★★★★**

Energy test program: Cotton ECO 60°C, Speed: the highest speed; Other as the default.

Half load for 6.0/7.0/8.0Kg machine:3.0/3.5/4.0Kg.

- "Cotton ECO 60°C " is the standard washing programs to which the information in the label and the fiche relates, and they are suitable to clean normally soiled cotton laundry and that they are the most efficient programmes in terms of combined energy and water consumptions for washing that type of cotton laundry, that the actual water temperature may differ from the declared cycle temperature.

Note!

- The parameters in this table are only for user's reference. The actual parameters maybe different with the parameters in above mentioned table.

MAINTENANCES

■ Cleaning And Care

Warning!

- Before your maintenance starts, please unplug the machine and close the tap.

Cleaning The Cabinet

Proper maintenance on the washing machine can extend its working life. The surface can be cleaned with diluted non-abrasive neutral detergents when necessary. If there is any water overflow, use the wet cloth to wipe it off immediately. No sharp items are allowed.

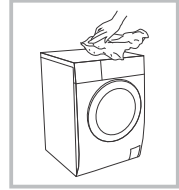

Note!

- Formic acid and its diluted solvents or equivalent are forbidden, such as alcohol, solvents or chemical products, etc.

Cleaning The Drum

The rusts left inside the drum by the metal articles shall be removed immediately with chlorine-free detergents. Never use steel wool.

Note!

- Don't put laundry in the washing machine during the drum cleaning.

Cleaning The Door Seal And Glass

Wipe the glass and seal after each wash to remove lint and stains. If lint builds up it can cause leaks. Remove any coins, buttons and other objects from the seal after each wash.

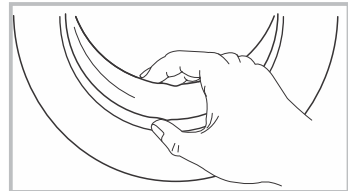

MAINTENANCES

Cleaning The Inlet Filter

Note!

- Inlet filter must be cleaned if there is less water.

Washing the filter in the tap

1. Close the tap.
2. Remove the water supply hose from the tap.
3. Clean the filter.
4. Reconnect the water supply hose.

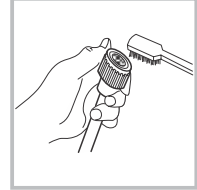
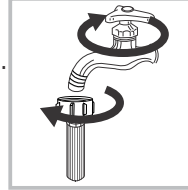

Washing the filter in washing machine:

1. Screw off the inlet pipe from the backside of the machine.
2. Pull out the filter with long nose pliers and reinstall it back after being washed.
3. Use the brush to clean the filter.
4. Reconnect the inlet pipe.

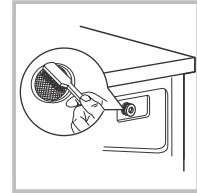
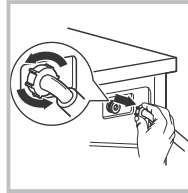

Note!

- If the brush is not clean, you can pull out the filter washed separately;
- Reconnect, turn on the tap.

Clean The Detergent Dispenser

1. Press down the arrow location on softener cover inside the dispenser drawer.
2. Lift the clip up and take out softener cover and wash all grooves with water.
3. Restore the softener cover and push the drawer into position.

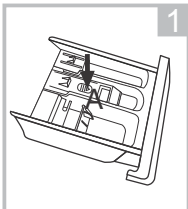

Pull out the dispenser drawer with press the A

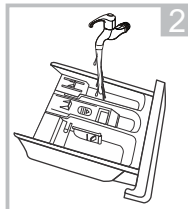

Clean the dispenser drawer under water

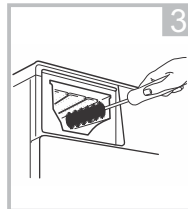

Clean inside the recess with an old toothbrush

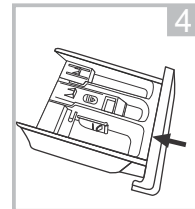

Insert the dispenser drawer

Note!

- Do not use alcohol, solvents or chemical products to clean the machine.

MAINTENANCES

Cleaning The Drain Pump Filter

⚠ Warning!

- Be careful of the hot water!
- Allow detergent solution to cool down.
- Unplug the machine to avoid electrical shock before washing.
- Drain pump filter can filter the yarns and small foreign matters from the washing.
- Clean the filter periodically to ensure the normal operation of washing machine.

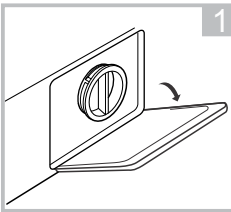

Open the lower cover cap

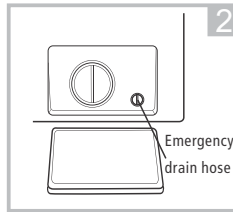

Rotate 90°C and pull out the emergency drain hose, and take off the hose cap

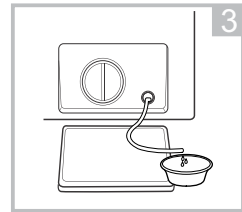

After water runs out, reset the drain hose

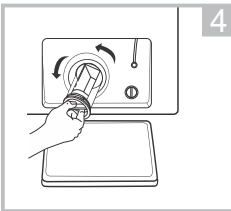

Open the filter by turning to the counter clockwise

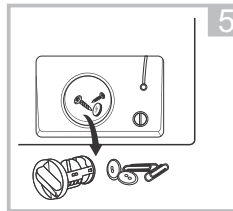

Remove extraneous matter

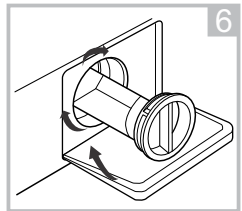

Close the lower cover cap

⚠ Caution!

- Make sure that valve cap and emergency drain hose are reinstalled properly, cap plates should be inserted aligning to hole plates otherwise water may leak.
- Some machines don't have emergency drain hose, so step 2 and step 3 can be skipped. Rotate lower cover cap directly to make water run into basin.
- When the appliance is in use and depending on the programme selected there can be hot water in the pump. Never remove the pump cover during a wash cycle, always wait until the appliance has finished the cycle, and is empty. When replacing the cover, ensure it is securely re-tightened.

MAINTENANCES

■ Trouble Shooting

The start of the appliance does not work or it stops during operation.
First try to find a solution to the problem, If not, contact the service centre.

Description	Reason	Solution
Washing machine cannot start up	Door is not closed properly	Restart after the door is closed Check if the clothes is stuck
Door can't be opened	Washer's safety protection design is working	Disconnect the power, restart the product
Water leakage	The connection between inlet pipe or outlet hose is not tight	Check and fasten water pipes Clean up outlet hose
Detergent residues in the box	Detergent is dampened or agglomerated	Clean and wipe the detergent box
Indicator or display does not light	Disconnect the power PC board or harness has connection problem	Check if the power is shut down and the power plug is connected correctly
Abnormal noise		Check if the fixing (bolts) have been removed Check it's installed on a solid and level floor

Description	Reason	Solution
E30	Door is not closed properly	Restart after the door is closed Check if the clothes is stuck
E10	Water injecting problem while washing	Check if the water pressure is too low Straighten the water pipe Check if the inlet valve filter is blocked
E21	Overtime water draining	Check if the drain hose is blocked
E12	Water overflow	Restart the washer
EXX	Others	Please try again first, call up service line if there are still troubles

Note!

- After the check, activate the appliance. If the problem occurs or the display shows other alarm codes again, contact the service.

MAINTENANCES

■ Technical Specifications

Power Supply 220-240V~,50Hz
 110-127V~60Hz(LA20/TW)

MAX.Current 10A

Standard Water Pressure 0.05MPa~1MPa

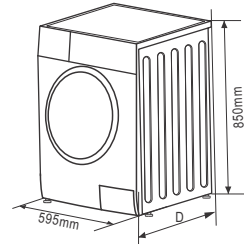

Model	Washing Capacity	Dimension (W*D*Hmm)	Net Weight	Rated Power
EU(A3)-FC60-S10/C1903E	6.0kg	595*470*850	54kg	2000W
EU(A3)-FC60-S12/C1903E				
EU(A3)-FC60-S14/C1903E				
MFC60-S1203/C14E-AE(5)				
MFC60-U1203/C19E-EU(A3)				
EU(A3)-FC70-S12/C1903E	7.0kg	595*495*850	61kg	2050W
EU(A3)-FC70-S14/C1903E				
IR(A3)-FC70-S14S/C1903E				
MFC70-S1203/C14E-AE(5)				
EU(A3)-FC80-S10/C1903E	8.0kg	595*565*850	68kg	2000W
EU(A3)-FC80-S12/C1903E				
EU(A3)-FC80-S14/C1903E				
IR(A3)-FC80-S14S/C1903E				
MFC80-S1403/C14E-AE(5)				
EU(A31)-FC90-S14D/C1903E	9.0kg	595*565*850	71kg	2000W
EU(A33)-FC100-U16B/C1903E	10.0kg	595*565*850	72kg	1950W
EU(A33)-FC120-U14B/C1903E	12.0kg	595*585*850	73kg	2000W
MFC120-U1403B/C19E-AR				
MFC120-U1403BS/C19E-LA20				1130W
MFC120-U1203B/C14E-TW				920W

Wuxi Little Swan Co., Ltd.
 No.18 Changjiang South Road, Wuxi City, Jiangsu Province, China

MAINTENANCES

■ Product Fiches

Model	EU(A3)-FC60-S10/C1903E
	EU(A3)-FC60-S12/C1903E
	EU(A3)-FC60-S14/C1903E
Capacity	6kg
Spin Speed	1000/1200/1400 rpm
Energy efficiency class	① A +++
Annual energy consumption	② 153 kWh /annual
Power consumption of off - mode	0.5W
Power consumption of Left on -mode	1.0W
Annual water consumption	③ 9240L /annual
Spin- drying efficiency class	④ C/B/B
Standard washing cycle	⑤ Cotton ECO
Energy consumption of the standard 60°C at full load	0.79 kwh /cycle
Energy consumption of the standard 60°C at partial load	0.64 kwh /cycle
Energy consumption of the standard 40° C at partial load	0.54kwh /cycle
Programme duration of standard 60° C at full load	179 min
Programme duration of standard 60°C at partial load	179min
Programme duration of standard 40°C at partial load	179 min
Water consumption of the standard 60° C at full load	48 L /cycle
Water consumption of standard 60°C at partial load	37L /cycle
Water consumption of the standard 40° C at partial load	37L /cycle
Remaining moisture content of the standard 60°C at full load	61/51/51%
Remaining moisture content of the standard 60°C at partial load	62/54/54%
Remaining moisture content of the standard 40°C at partial load	62/54/54%
Noise level of washing	59dB (A)
Noise level of spinning	74/76/78dB (A)

MAINTENANCES

Model		EU(A3)-FC70-S12/C1903E
		EU(A3)-FC70-S14/C1903E
		IR(A3)-FC70-S14S/C1903E
Capacity		7kg
Spin Speed		1200/1400/1400 rpm
Energy efficiency class	①	A+++
Annual energy consumption	②	175 kWh /annual
Power consumption of off - mode		0.5W
Power consumption of Left on -mode		1.0W
Annual water consumption	③	10000L /annual
Spin- drying efficiency class	④	B/B
Standard washing cycle	⑤	Cotton ECO
Energy consumption of the standard 60°C at full load		0.93 kwh /cycle
Energy consumption of the standard 60°C at partial load		0.80 kwh /cycle
Energy consumption of the standard 40° C at partial load		0.51kwh /cycle
Programme duration of standard 60° C at full load		179 min
Programme duration of standard 60°C at partial load		179min
Programme duration of standard 40°C at partial load		179min
Water consumption of the standard 60° C at full load		50L /cycle
Water consumption of standard 60°C at partial load		42L /cycle
Water consumption of the standard 40° C at partial load		42L /cycle
Remaining moisture content of the standard 60°C at full load		51%
Remaining moisture content of the standard 60°C at partial load		54%
Remaining moisture content of the standard 40°C at partial load		54%
Noise level of washing		59dB (A)
Noise level of spinning		76/78dB (A)

MAINTENANCES

Model		EU(A3)-FC80-S12/C1903E
		EU(A3)-FC80-S14/C1903E
Capacity		8kg
Spin Speed		1200/1400 rpm
Energy efficiency class	①	A+++
Annual energy consumption	②	196 kWh /annual
Power consumption of off - mode		0.5W
Power consumption of Left on -mode		1.0W
Annual water consumption	③	11000L /annual
Spin- drying efficiency class	④	B/B
Standard washing cycle	⑤	Cotton ECO
Energy consumption of the standard 60°C at full load		1.05 kwh /cycle
Energy consumption of the standard 60°C at partial load		0.84 kwh /cycle
Energy consumption of the standard 40° C at partial load		0.63kwh /cycle
Programme duration of standard 60° C at full load		179 min
Programme duration of standard 60°C at partial load		179min
Programme duration of standard 40°C at partial load		179 min
Water consumption of the standard 60° C at full load		55L /cycle
Water consumption of standard 60°C at partial load		45L /cycle
Water consumption of the standard 40° C at partial load		45L /cycle
Remaining moisture content of the standard 60°C at full load		51%
Remaining moisture content of the standard 60°C at partial load		54%
Remaining moisture content of the standard 40°C at partial load		54%
Noise level of washing		59dB (A)
Noise level of spinning		76/78dB (A)

MAINTENANCES

Model	EU(A31)-FC90-S14D/C1903E	
Capacity	9kg	
Spin Speed	1400 rpm	
Energy efficiency class	①	A +++
Annual energy consumption	②	196 kWh /annual
Power consumption of off - mode	0.5W	
Power consumption of Left on -mode	1.0W	
Annual water consumption	③	11800L /annual
Spin- drying efficiency class	④	B
Standard washing cycle	⑤	Cotton ECO
Energy consumption of the standard 60°C at full load	0.93 kwh /cycle	
Energy consumption of the standard 60°C at partial load	0.93kwh /cycle	
Energy consumption of the standard 40° C at partial load	0.72kwh /cycle	
Programme duration of standard 60° C at full load	228min	
Programme duration of standard 60°C at partial load	219min	
Programme duration of standard 40°C at partial load	213min	
Water consumption of the standard 60° C at full load	57L /cycle	
Water consumption of standard 60°C at partial load	51L /cycle	
Water consumption of the standard 40° C at partial load	51L /cycle	
Remaining moisture content of the standard 60°C at full load	50%	
Remaining moisture content of the standard 60°C at partial load	55%	
Remaining moisture content of the standard 40°C at partial load	55%	
Noise level of washing	54dB (A)	
Noise level of spinning	76dB (A)	

MAINTENANCES

Model	EU(A33)-FC100-U16B/C1903E	
Capacity	10kg	
Spin Speed	1600 rpm	
Energy efficiency class	①	A+++
Annual energy consumption	②	167 kWh /annual
Power consumption of off - mode	0.5W	
Power consumption of Left on -mode	1.0W	
Annual water consumption	③	13000L /annual
Spin- drying efficiency class	④	A
Standard washing cycle	⑤	Cotton ECO
Energy consumption of the standard 60°C at full load	0.77 kwh /cycle	
Energy consumption of the standard 60°C at partial load	0.77 kwh /cycle	
Energy consumption of the standard 40° C at partial load	0.66 kwh /cycle	
Programme duration of standard 60° C at full load	239 min	
Programme duration of standard 60°C at partial load	239min	
Programme duration of standard 40°C at partial load	233 min	
Water consumption of the standard 60° C at full load	60L /cycle	
Water consumption of standard 60°C at partial load	58L /cycle	
Water consumption of the standard 40° C at partial load	58L /cycle	
Remaining moisture content of the standard 60°C at full load	42 %	
Remaining moisture content of the standard 60°C at partial load	45 %	
Remaining moisture content of the standard 40°C at partial load	45 %	
Noise level of washing	54dB (A)	
Noise level of spinning	78dB (A)	

MAINTENANCES

Model	EU(A33)-FC120-U14B/C1903E	
Capacity	12kg	
Spin Speed	1600 rpm	
Energy efficiency class	①	A +++
Annual energy consumption	②	197 kWh /annual
Power consumption of off - mode	0.5W	
Power consumption of Left on -mode	1.0W	
Annual water consumption	③	14000L /annual
Spin- drying efficiency class	④	B
Standard washing cycle	⑤	Cotton ECO
Energy consumption of the standard 60°C at full load	0.90 kwh /cycle	
Energy consumption of the standard 60°C at partial load	0.90 kwh /cycle	
Energy consumption of the standard 40° C at partial load	0.82 kwh /cycle	
Programme duration of standard 60° C at full load	239 min	
Programme duration of standard 60°C at partial load	239min	
Programme duration of standard 40°C at partial load	235 min	
Water consumption of the standard 60° C at full load	65L /cycle	
Water consumption of standard 60°C at partial load	62L /cycle	
Water consumption of the standard 40° C at partial load	62L /cycle	
Remaining moisture content of the standard 60°C at full load	50 %	
Remaining moisture content of the standard 60°C at partial load	55 %	
Remaining moisture content of the standard 40°C at partial load	55%	
Noise level of washing	54dB (A)	
Noise level of spinning	76dB (A)	

MAINTENANCES

Model	MFC60-U1203/C19E-EU(A3)
Capacity	6kg
Spin Speed	1200 rpm
Energy efficiency class	① A +++
Annual energy consumption	② 153 kWh /annual
Power consumption of off - mode	0.5W
Power consumption of Left on -mode	1.0W
Annual water consumption	③ 9240L /annual
Spin- drying efficiency class	④ B
Standard washing cycle	⑤ Cotton ECO
Energy consumption of the standard 60°C at full load	0.73 kwh /cycle
Energy consumption of the standard 60°C at partial load	0.63 kwh /cycle
Energy consumption of the standard 40° C at partial load	0.63 kwh /cycle
Programme duration of standard 60° C at full load	300 min
Programme duration of standard 60°C at partial load	280 min
Programme duration of standard 40°C at partial load	280 min
Water consumption of the standard 60° C at full load	48L /cycle
Water consumption of standard 60°C at partial load	37L /cycle
Water consumption of the standard 40° C at partial load	37L /cycle
Remaining moisture content of the standard 60°C at full load	50 %
Remaining moisture content of the standard 60°C at partial load	55 %
Remaining moisture content of the standard 40°C at partial load	55%
Noise level of washing	59dB (A)
Noise level of spinning	76dB (A)

MAINTENANCES

Note!

- Programme setting for testing in accordance with applicable standard En60456.
- When using the test programmes, wash the specified load using the maximum spin speed.
- The actual parameters will depend on how the appliance is used, and maybe different with the parameters in above mentioned table.
- The household washing machine is equipped with power management system. The duration of the left-on mode time is less than 1 minute.
- The noise emissions during washing/spinning for the standard washing cycle at full load.

Remarks:

- ① The energy efficiency class is from A (highest efficiency) to D (lowest efficiency).
- ② Energy consumption per year, based on 220 standard washing cycles for standard programme at 60°C and 40°C at full and partial load, and the consumption of the low-power modes. Actual energy consumption will depend on how the appliance is used.
- ③ Water consumption per year based on 220 standard washing cycles for standard programme at 60°C and 40°C at full and partial load. Actual water consumption will depend on how the appliance is used.
- ④ Spin-drying efficiency class from G (least efficient) to A (most efficient).
- ⑤ The standard 60°C programme and the standard 40°C programme are the standard washing programmes. These programmes are suitable to clean normally soiled cotton laundry and they are the most efficient programmes in terms of combined energy and water consumptions for washing that type of cotton laundry. The actual water temperature may differ from the declared cycle temperature.
Please choose the suitable type of detergent for the various washing temperatures to get the best washing performance with less water and energy consumption.